

DAR CONSTITUTION HALL

TECHNICAL INFORMATION

Stage Elevation	2
Stage Specifications	3
Stage Extension	4
Power, Audio, Followspots	5
Lighting	6
Load-in Entrances	7
Seating Chart	8
Backstage Layout—Stage level	9
Backstage Layout—Lower Level	10
Lobby and Lounge Layout	11
Building Map	12
Aerial photo and Local Map	13
Production Policies	14, 15
Vendor List	16

STAGE ELEVATION

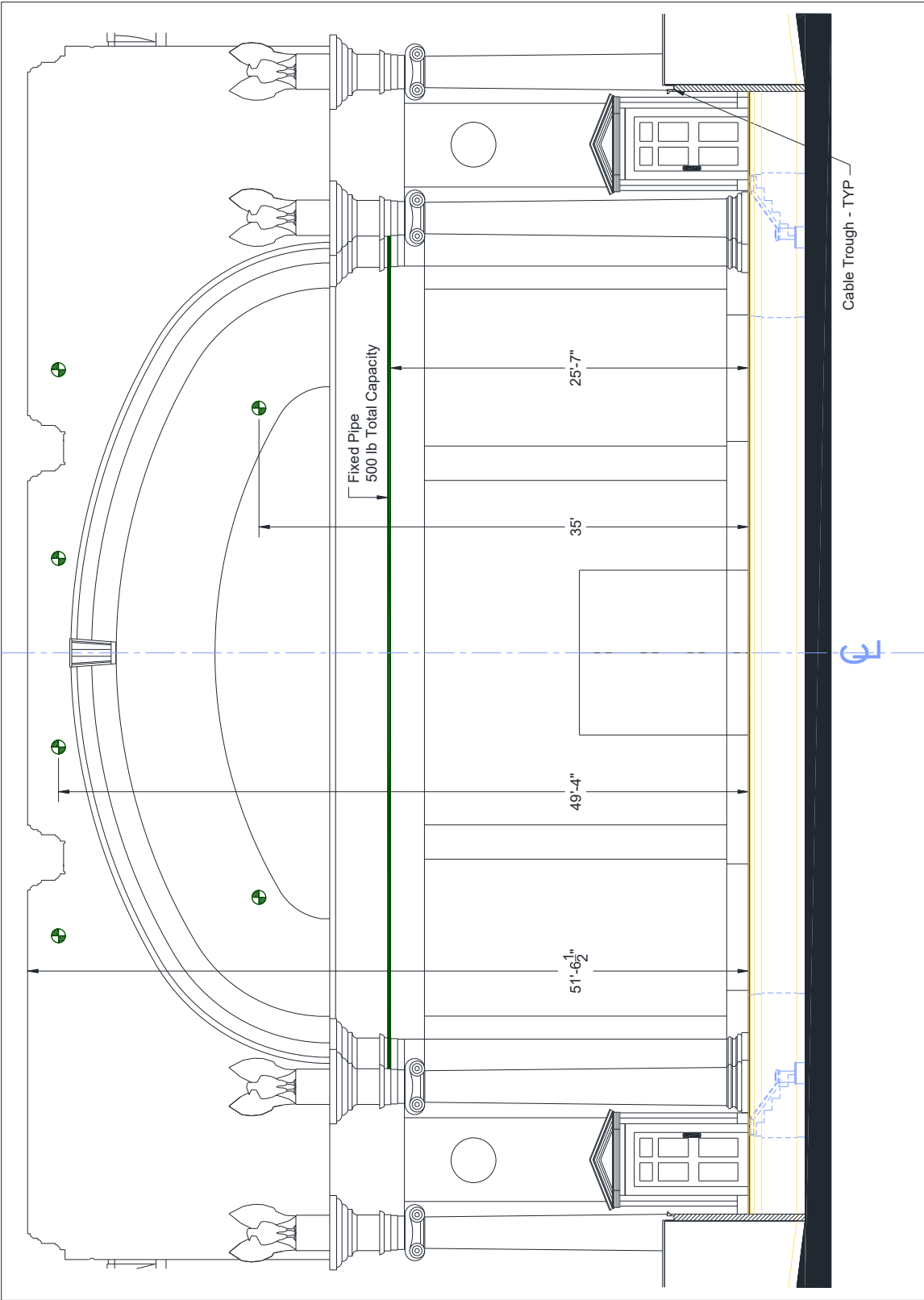

STAGE SPECIFICATIONS

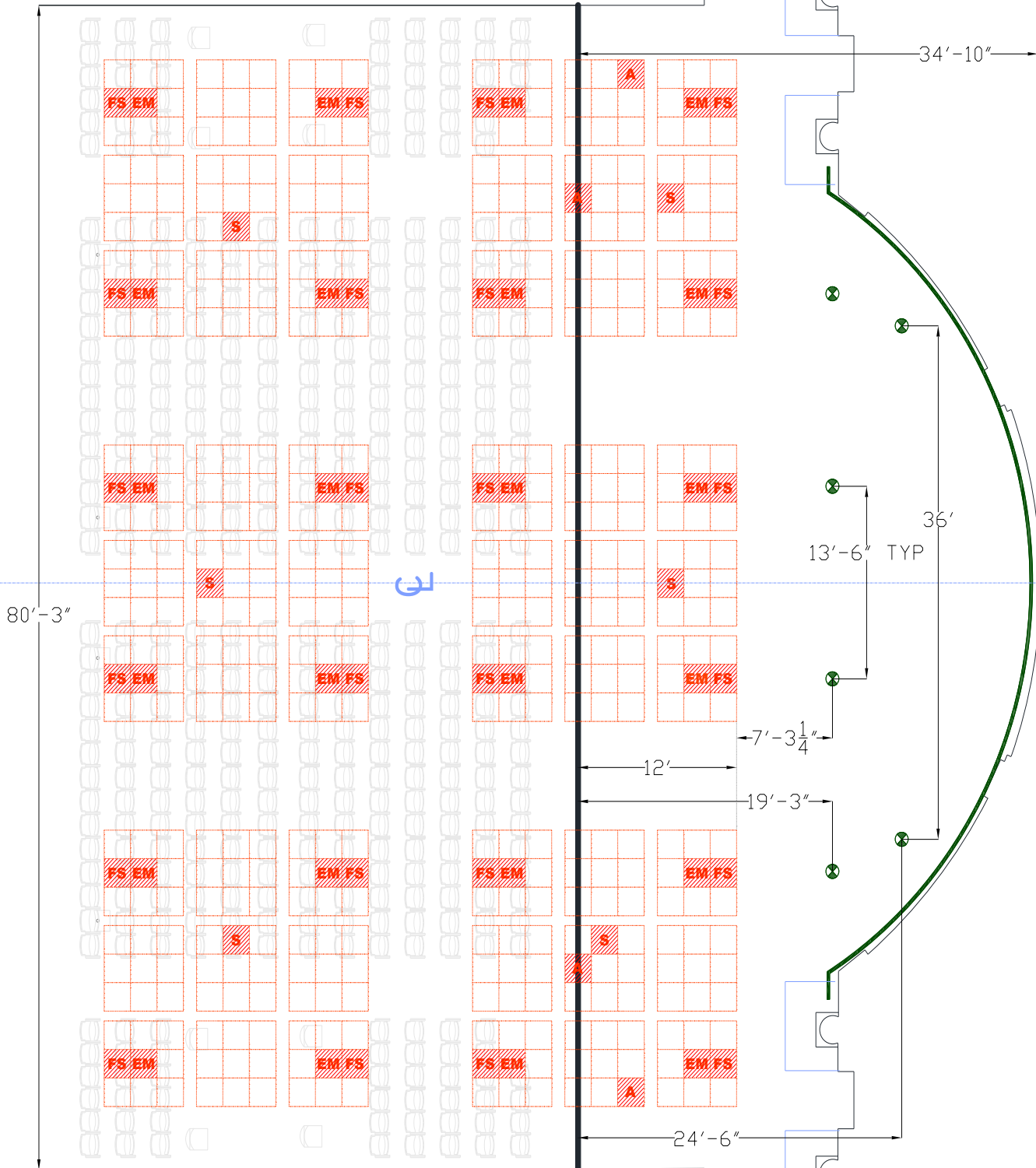

- Fixed rigging point
- Removable laylight panel
- Non-removable panel
- Smoke detector
- Fire Suppression
- EMergency light
- House Audio position

STAGE EXTENSION

Optional Stage Extension

Up to 80' wide x 20' deep

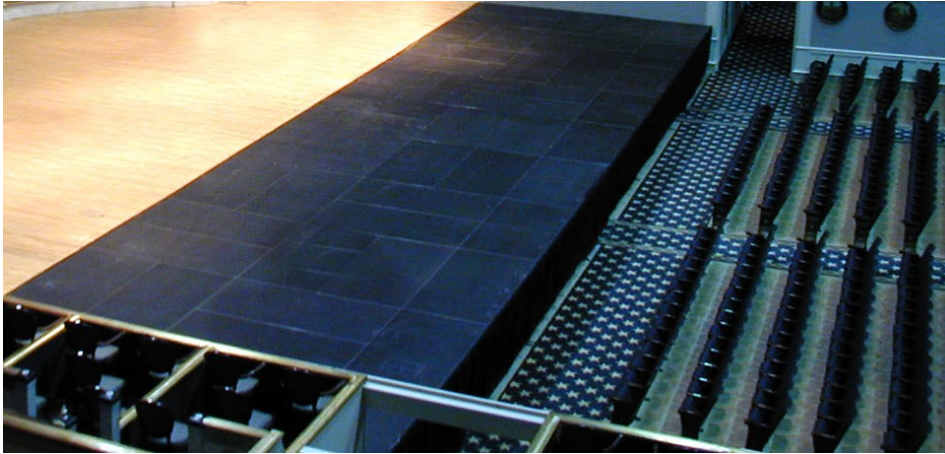

The stage of DAR Constitution Hall may be extended in a wide variety of patterns to accommodate larger events.

The on site equipment includes fifty pieces of 4' x 8' Wenger Versalite staging and two Wenger adjustable stair units. The same pieces can be used for camera platforms, press platforms and stage risers.

DAR Constitution Hall must arrange all stage extensions. See schedule of rates for pricing.

When employing the full stage extension, 302 seats in rows A through H become unusable.

-60 Box seats are just off from the stage, with 40 of them looking at the back of the performer.

-404 Tier seats are also looking downstage toward the back of the performer.

Total Number of Seats = 3696

Physical Kills = 302

Obstructed Box Seats = 60

Obstructed Tier Seats = 404

Total Remaining Seats = 2930

Extension Depth	1st Possible Seated Row	Recommended 1st Row
4'	B	C
8'	D	D
12'	E	F
16'	G	G
20'	H	J

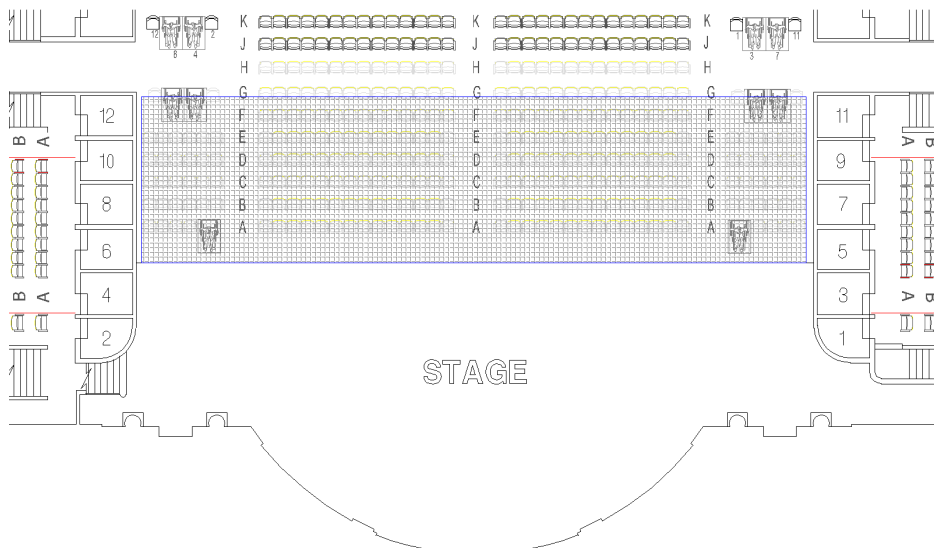

POWER, AUDIO, FOLLOWSPOTS

Power Specifications

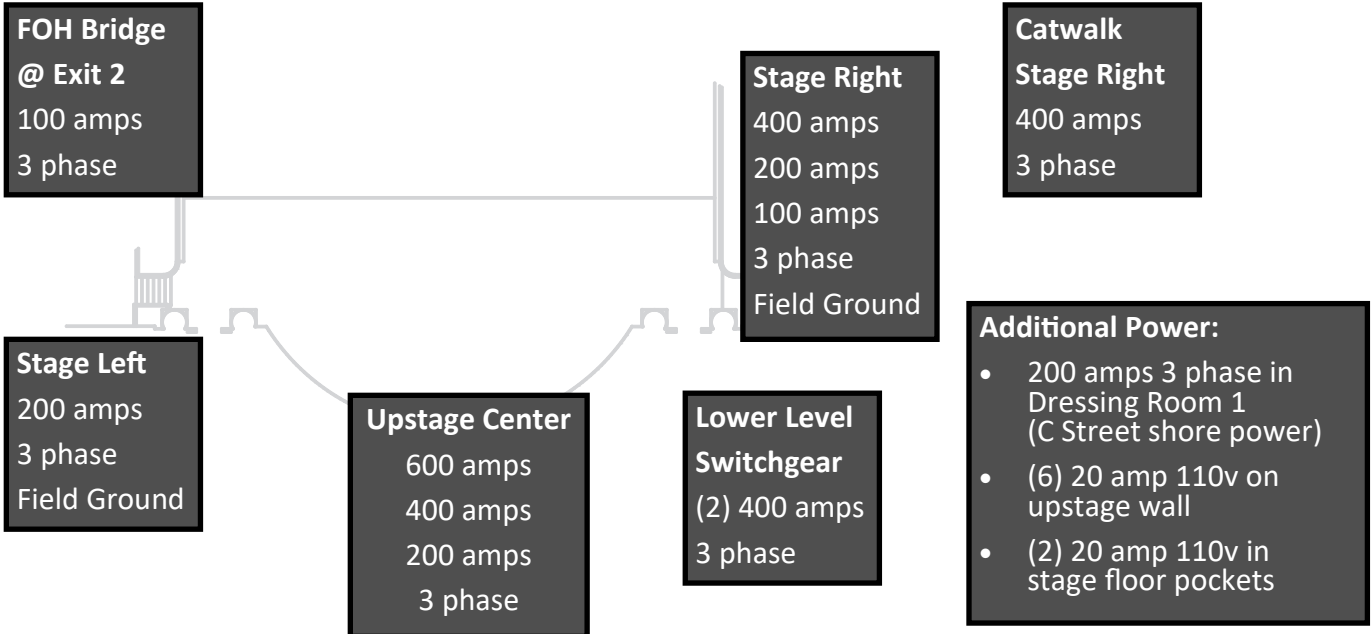

House Audio

- Martin WPM Line Arrays mains
- Martin iK81 Amplifiers
- Lake LM44 processor
- Shure ULX-D 4 Channel
- Meyer M1D Line Array side hangs and front lip fills
- Clark Technik digital delays, Yamaha and Digitech equalizers

Pianos

- Steinway D 9' Concert Grand
- Yamaha GC-2 Baby Grand
- Sohmer 45S Upright

Followspots

House Right Tier
(1) 2000W Xenon
Lycian 1290 XLT

House Left Tier
(1) 2000W Xenon
Lycian 1290 XLT

Upper Spotlight Booth
(2) 2000W Xenon
Lycian 1290 XLT

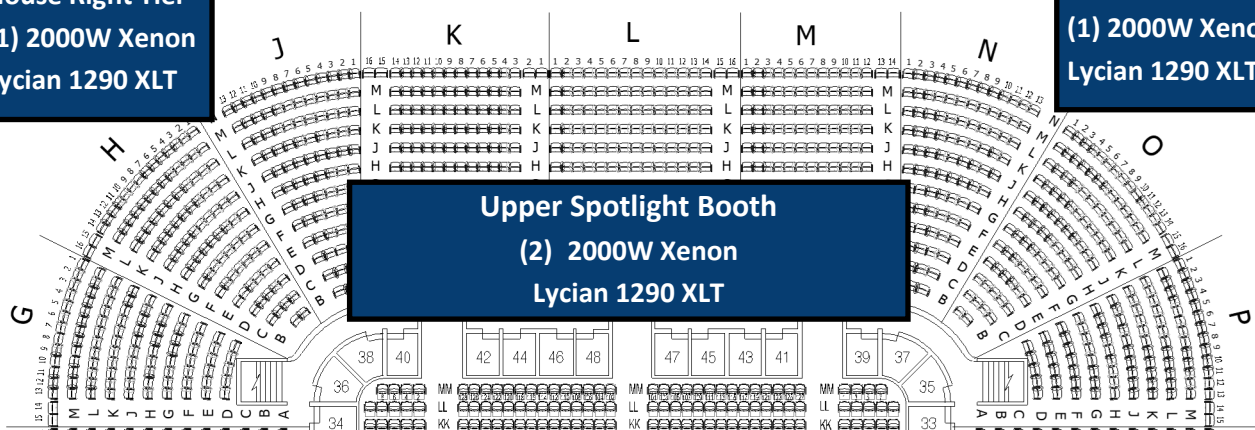

LIGHTING

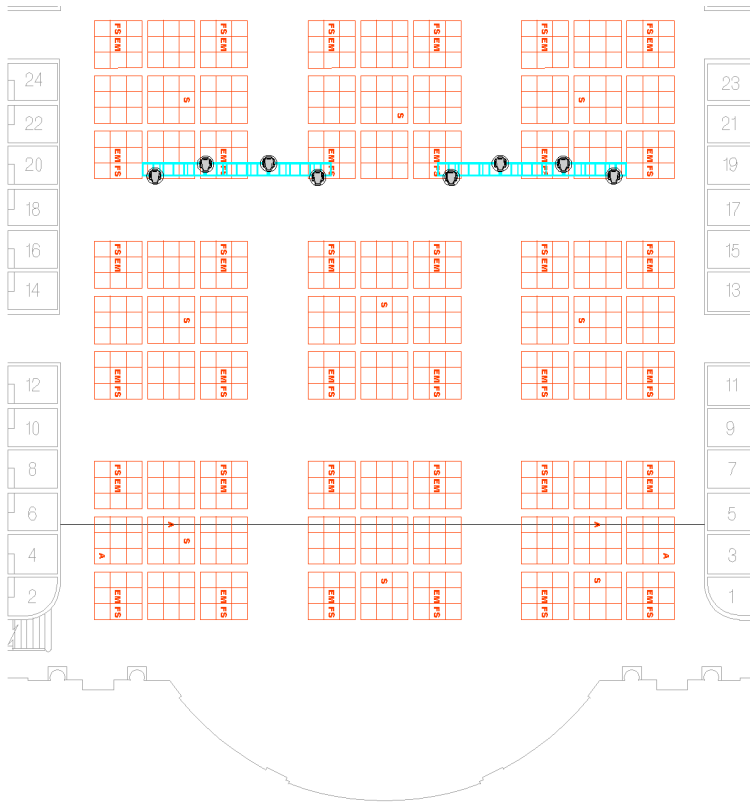

← FOH Trusses

- (2) 24' sections of 26" x 30" box truss
- (8) MAC Viper Performance
- 45' feet from downstage edge

Additional Lighting Inventory

- (8) MAC Aura XB
- MA dot2 XL-F

Upstage LEDs

Fully customizable color and natural white LED fixtures installed amid the upstage architecture.



- 25 Color Kinetics ColorBlast 12 PowerCore (dome)
- 20 iColor Cove MX PowerCore (eagles)



- Natural White 4000k LED in two dimmable zones (State Names and Dome/Eagles)

Laylight LED Panels

972 LED panels replicating the original laylight ceiling.

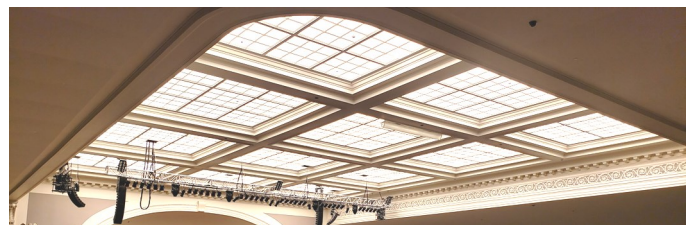

Daylight

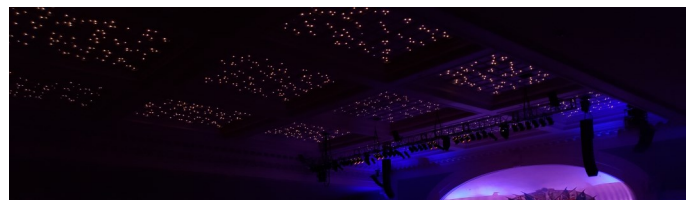

Starlights

LOAD-IN ENTRANCES

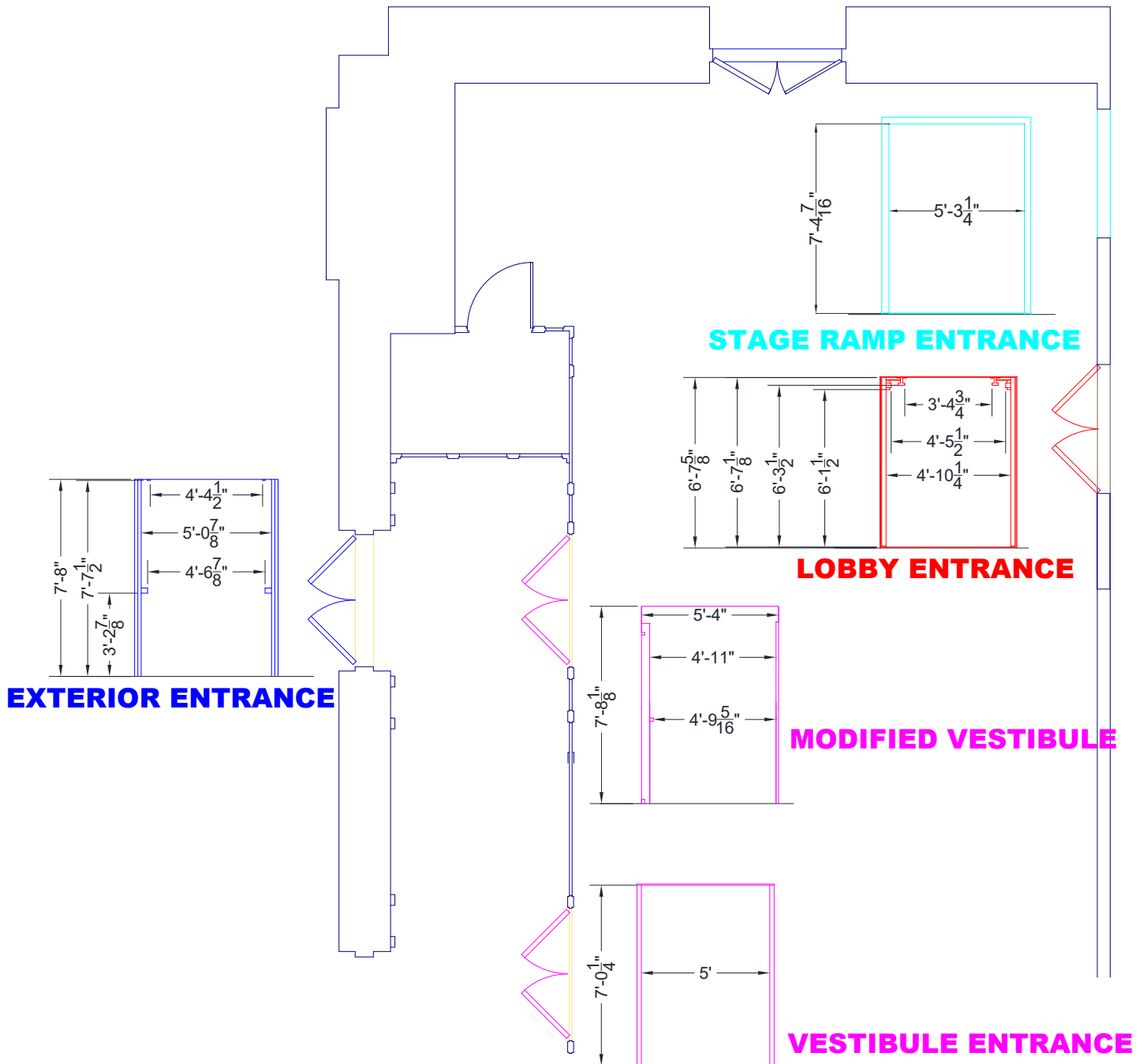

NOTE:

All scenery and support items must fit through Exterior, Vestibule and Stage Ramp door sizes to make it to the stage. Any scenery over 18'-0" in length, must be hand carried into the building through the 18th Street Entrance.

SEATING CHART

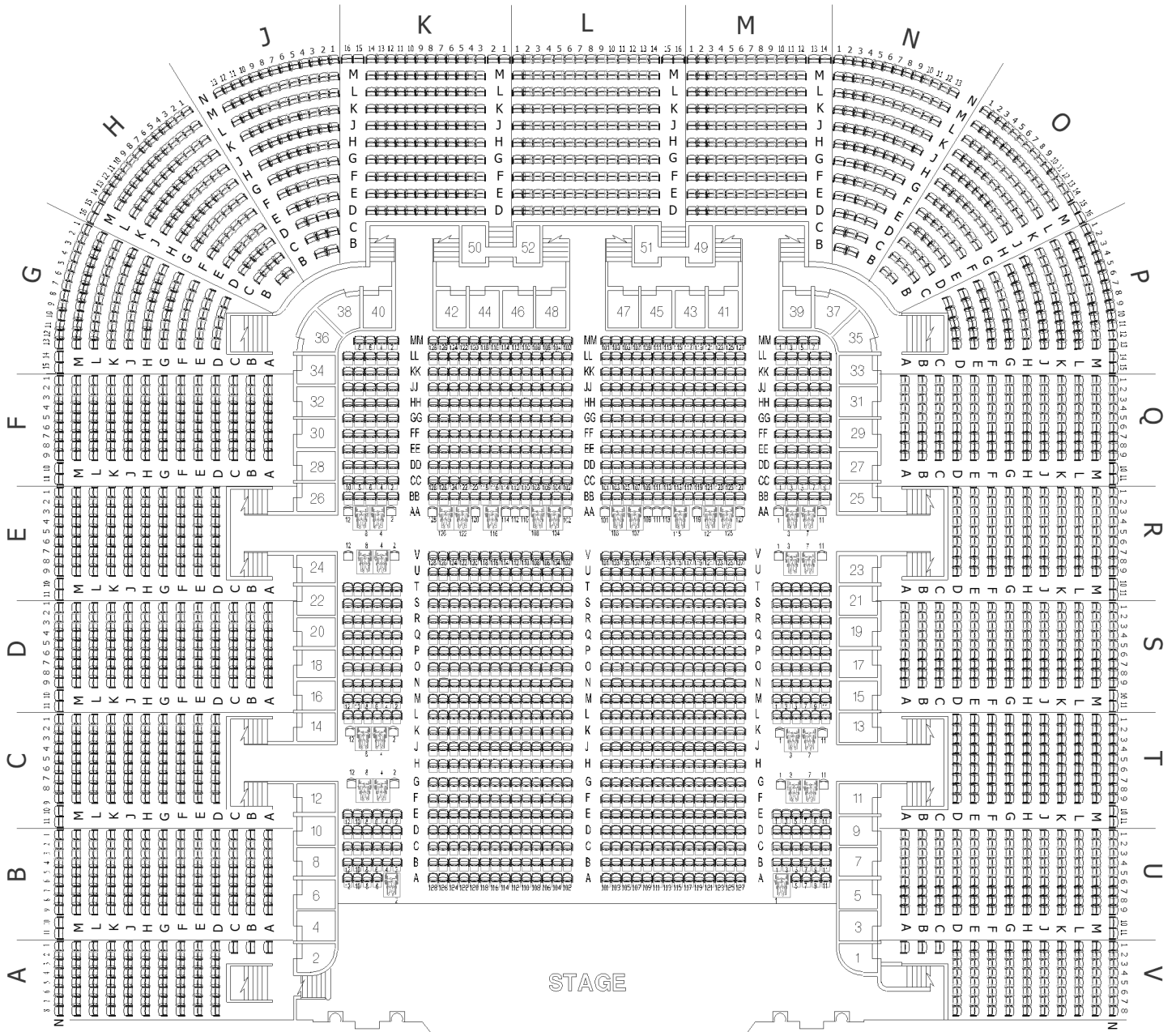

STAGE LEVEL DRESSING ROOMS

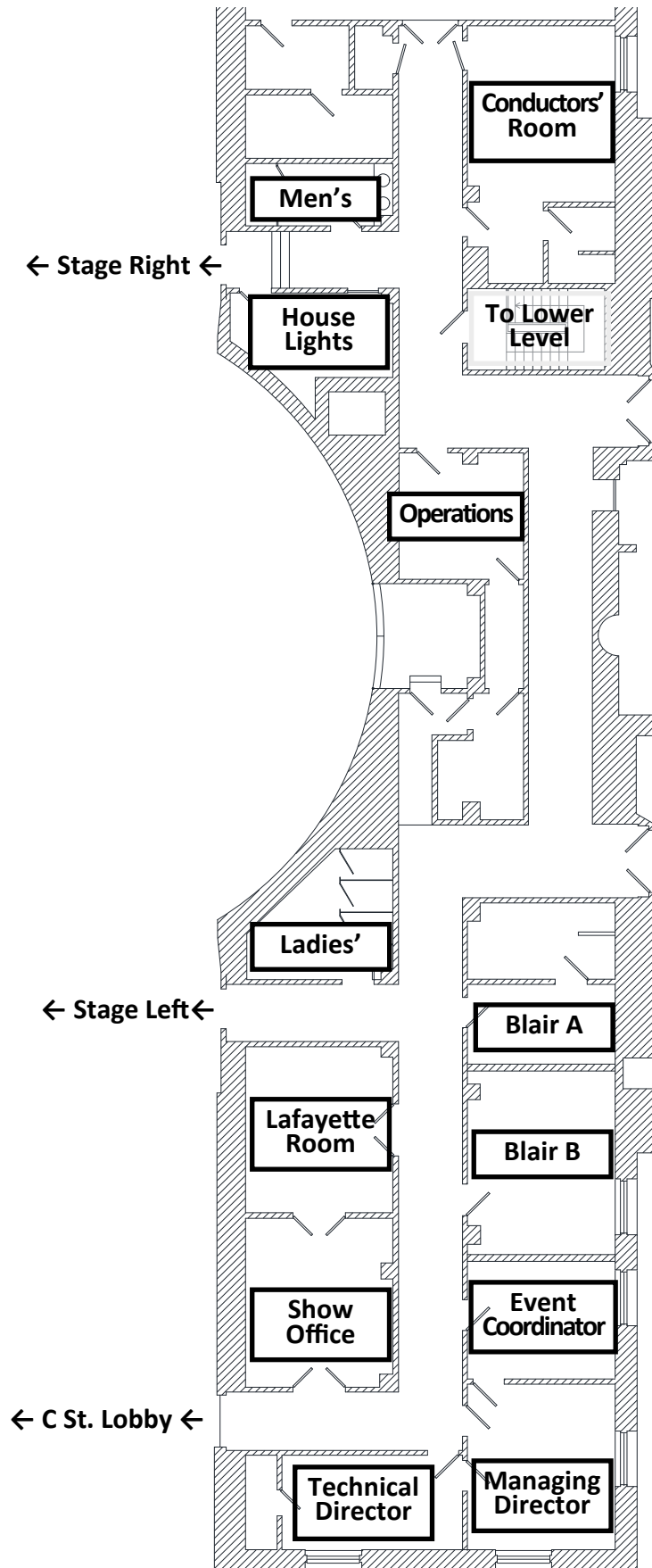

LOWER LEVEL DRESSING ROOMS

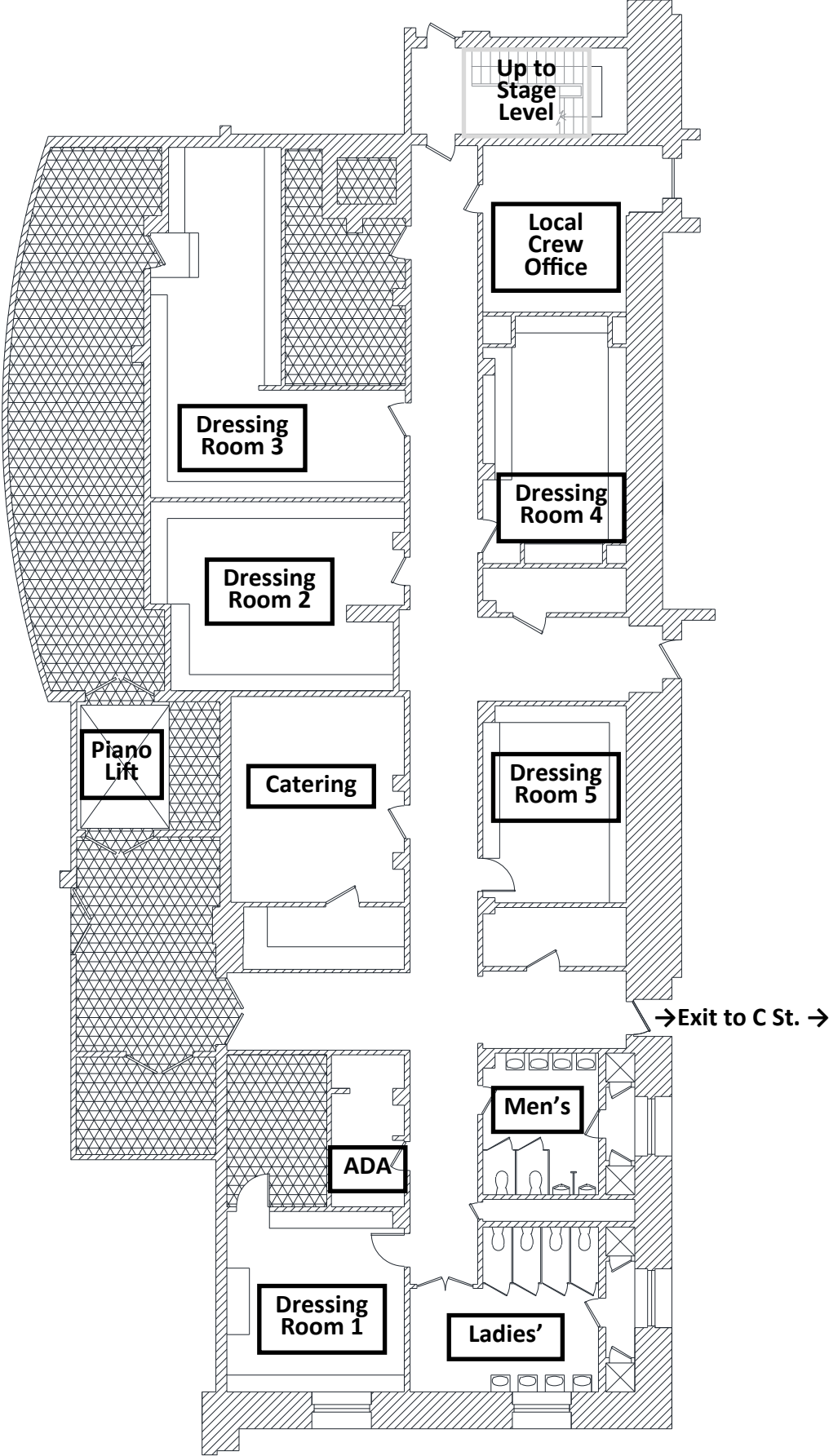

LOBBY AND LOUNGE

D Street

18th Street

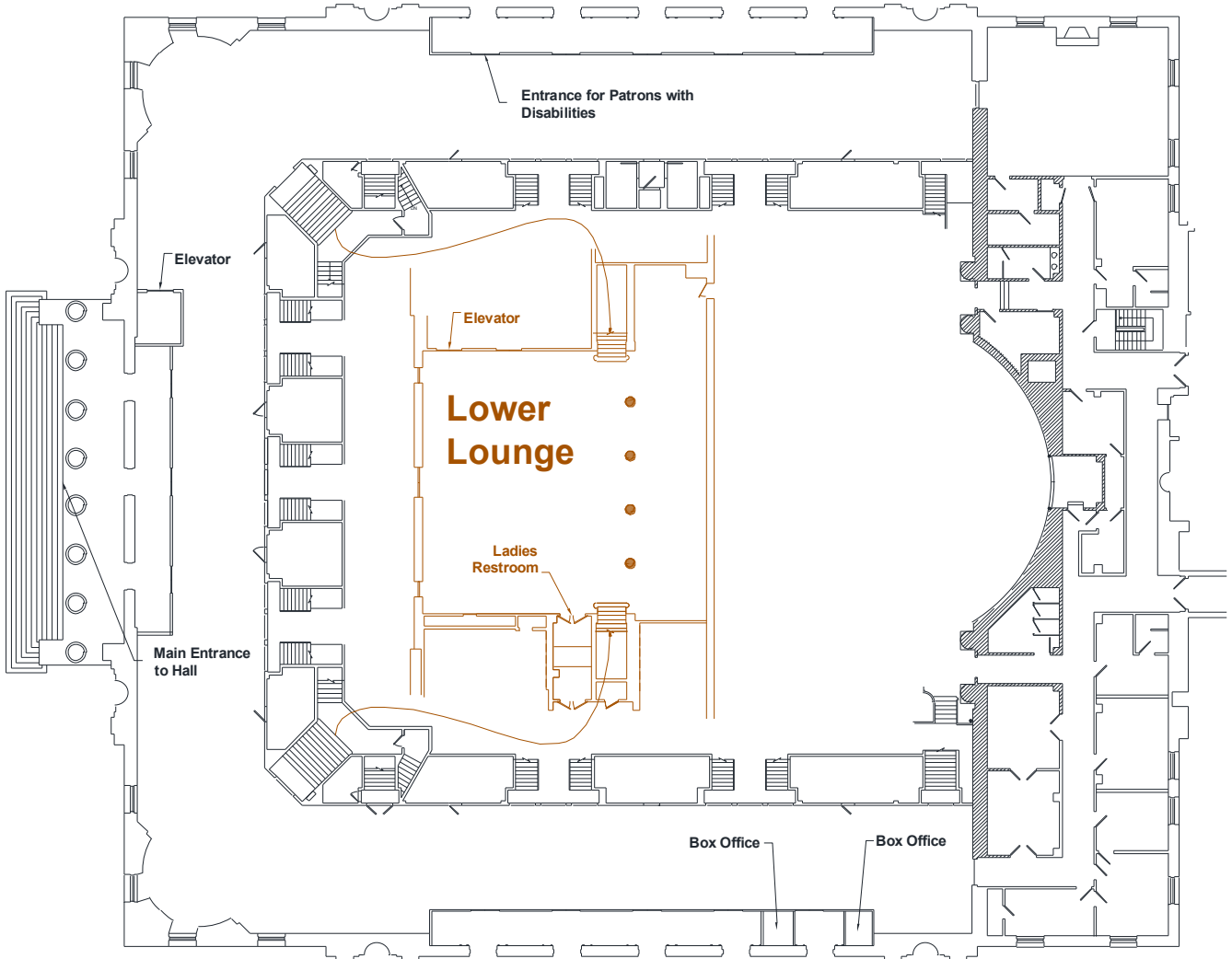

C Street

*Over 10,000 square feet of space suitable
for receptions, displays or exhibitions*

BUILDING MAP

All parking must be arranged in advance with the DC Government, as the meters must be permitted for indicated parking arrangements.

17th Street

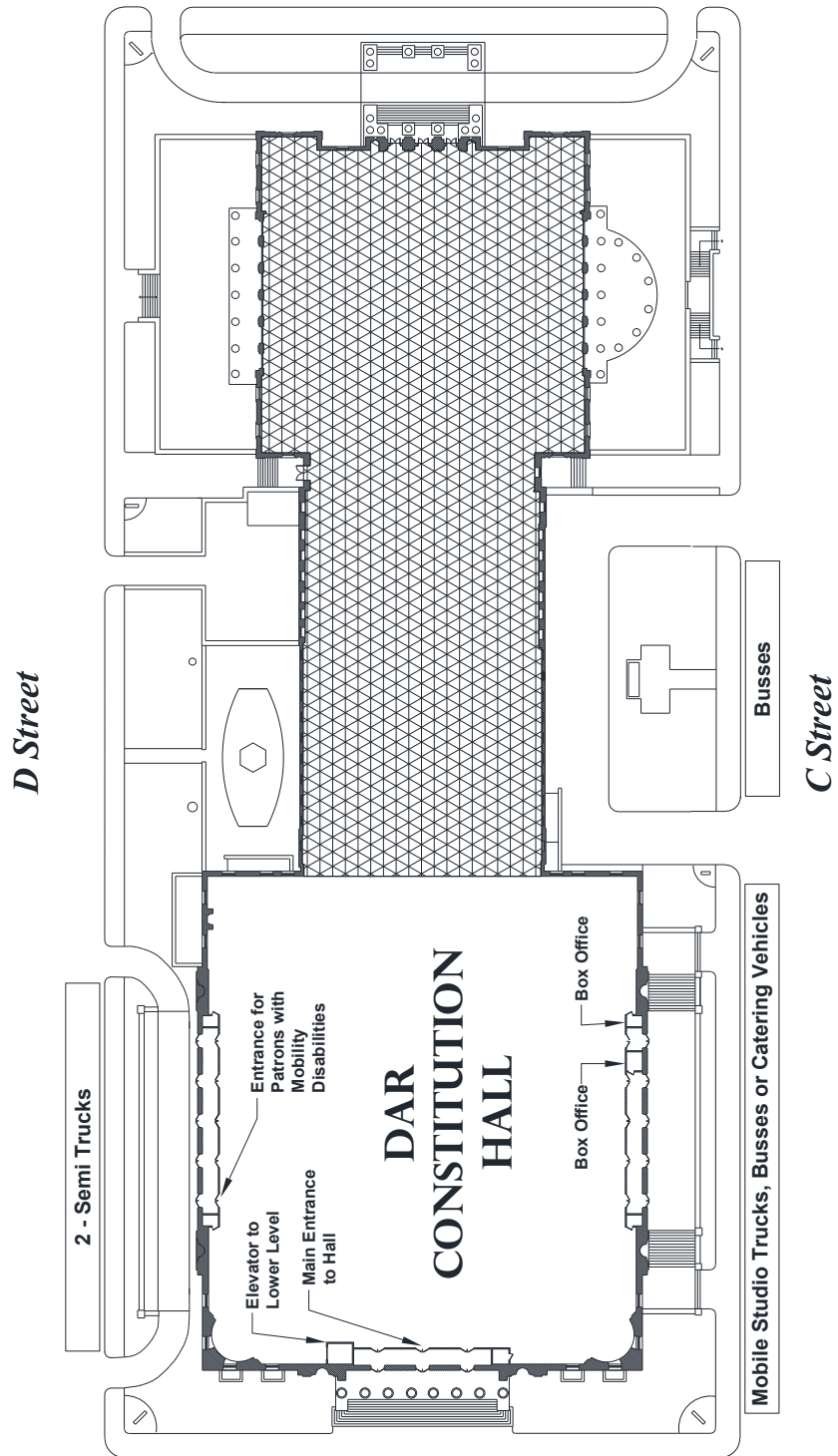

18th Street

BUILDING PHOTO AND LOCAL MAP

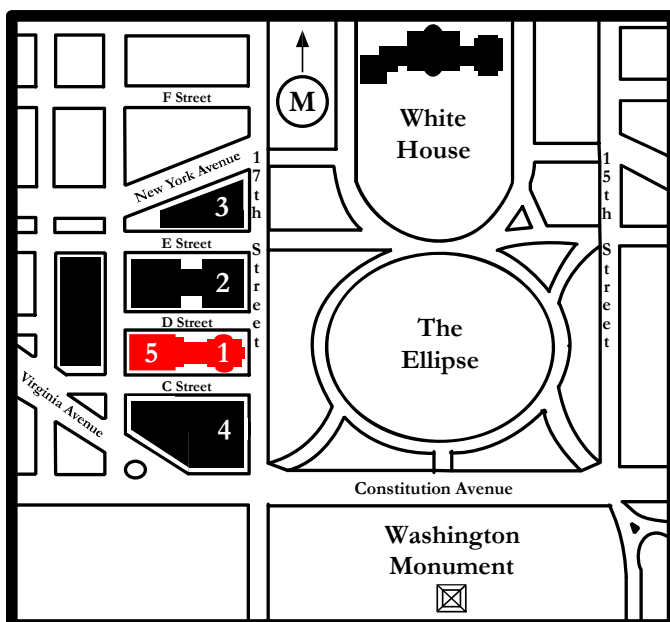
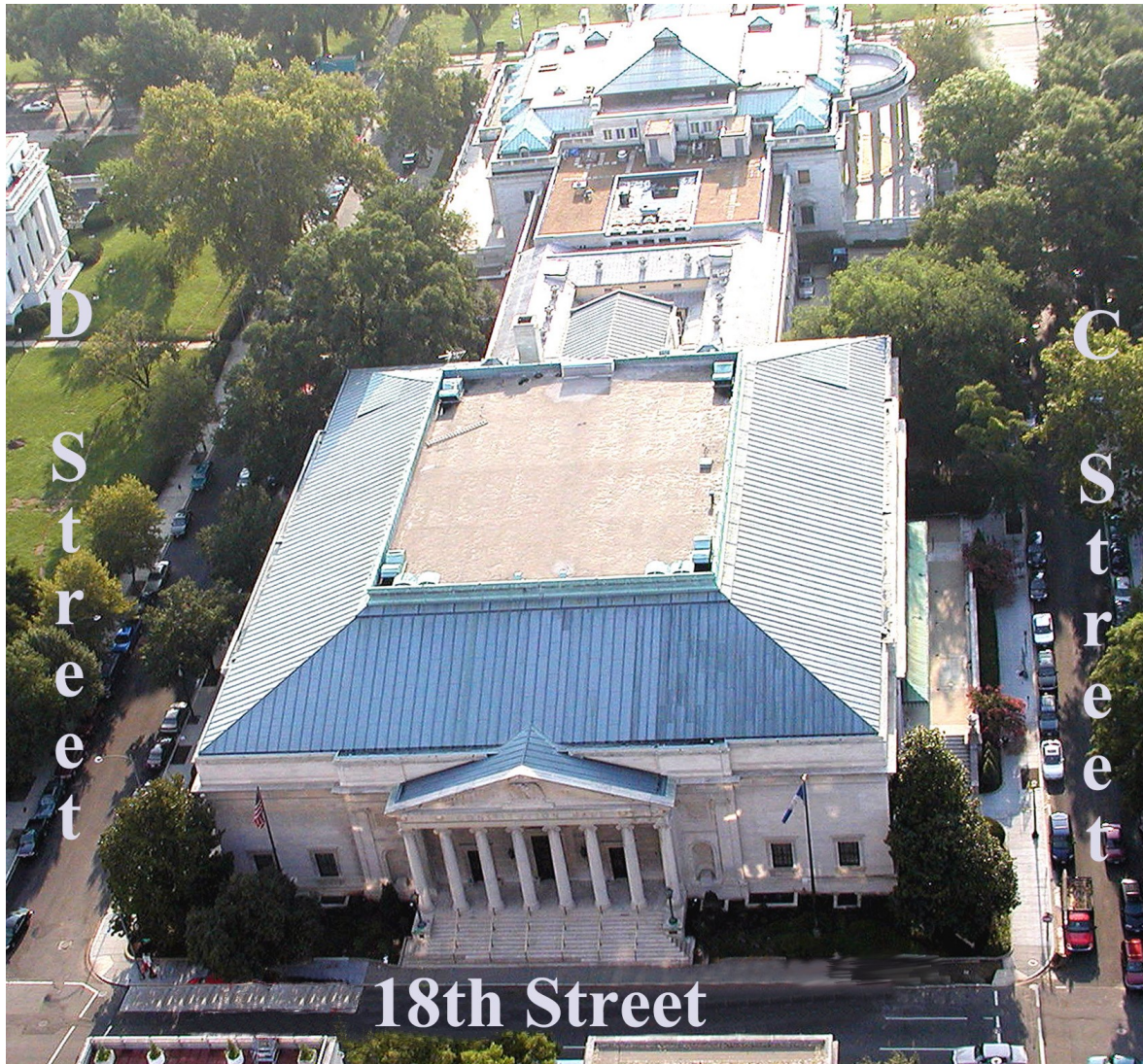

MAP KEY

1. The National Society Daughters of the American Revolution
2. The American Red Cross
3. The Corcoran Gallery of Art
4. The Organization Of American States
5. DAR Constitution Hall

PRODUCTION POLICIES

1. SPECIAL FX

a. HAZE

- i. Constitution Hall allows the use of white mineral oil fluids for haze effects, like Reel EFX Diffusion Fluid or MDG Neutral Fluid. (Most popular option is DF50.)
- ii. **Constitution Hall does NOT allow water-based** aka glycol fluids or glycol/water mixtures, regardless of whether they are considered haze or fog effects. (The most popular of these **prohibited** systems is the F100.)
- iii. Production must get approval from the stage crew electrician and building operator prior to running hazers.

b. CO2

- i. Pursuant to DC Code F-105.6.8, a permit is required for the use of compressed gases, including inert gases like CO2. Event organizer must procure their permit directly through the DC FEMS department.
- ii. Constitution Hall cannot arrange, receive or store CO2 deliveries on behalf of the event. CO2 must arrive and be clear of premises within the duration of the event license window.

c. NO CONFETTI

- i. Absolutely no confetti under any circumstances.

2. RAMPED LOAD-IN

a. **NO TRUCKS OF ANY SIZE MAY PASS UNDER THE AWNING.**

- b. Constitution Hall does not have a loading dock, but rather a ramped loading entrance.
- c. All production vehicles should have a ramp or a liftgate.
- d. Constitution Hall does not provide a forklift. If required, forklift should be arranged directly by the event organizer. Constitution Hall cannot arrange or receive this delivery.

3. FLOOR PROTECTION

- a. Masonite or other approved floor protection must be in place before rolling cases over the carpeted areas of Constitution Hall.
- b. Constitution Hall has enough Masonite available for standard concert production.
- c. All floor protection should be installed by the designated stage crew as part of the labor call and should be struck prior to doors to the public.
- d. Likewise, it should be reinstalled at the start of the load-out and struck prior to the end.

4. PROTECTION OF OTHER SURFACES

- a. Care should be taken to protect finished surfaces of the venue, and not use them as a place to lay or lean equipment or cases.
- b. This includes not leaning cases, case lids or equipment on plaster walls, against the columns or acoustic material of the orchestra wall, or against the upstage blue drape or the upstage mural.
- c. Cases, case lids and equipment should never be set on the seating at any time.

5. BOX SEATS

- a. The designated stage crew must remove and store any box seats that need to be removed for technical control positions or any other purpose.
- b. Technicians and show crew may not utilize the box chairs for their positions or workstations. Appropriate seating is available.

6. NO FOOD OR BEVERAGE IN THE AUDITORIUM

- a. Except bottles of water

7. SOUND CHECKS

- a. Sound checks may not commence until 4 PM on a DAR workday without prior approval by Constitution Hall staff.

PRODUCTION POLICIES CONT'D

8. CABLING

- a. Under no circumstances may cables cross walkways, whether in front-of-house or back-of-house locations. Taping or matting cabling is **NOT** an acceptable solution to this problem. All cables must run in a configuration that does not in any way present a potential trip hazard.

9. EXITS

- a. Exit doors may not be blocked at any time. Equipment must be stored in a way that does not block egress in case of an emergency. This applies to the entire event day, including load-in, the performance, and load-out.

10. ADHESIVES

- a. Constitution Hall does not permit tapes or other adhesive materials to be applied to any finished surfaces. Most significantly, this means that nothing may be taped to walls, floors, doors or carpet. There are no exceptions to this prohibition.
- b. Only approved tapes can be utilized on the stage itself and only by the designated stage crew.

11. CAMERA EQUIPMENT

- a. Tripods are not permitted in any area where the public may be seated. Tripods are only permitted in boxes that are completely clear of chairs or on the bridges over exits.
- b. Any video cameras inside the auditorium seating area must be wireless or accompanied by personnel paging cable for the operator.
- c. Purpose of camera equipment (i.e. IMAG, archival, promotional, broadcast, streaming) must be provided in writing to Constitution Hall staff prior to load-in.

12. ANIMALS

- a. Recognized service animals accompanying an individual with a disability, as defined by the ADA, are the only animals permitted inside Constitution Hall.
- b. No pets, comfort or support animals, regardless of size, are permitted under any circumstances to accompany any patron, staff or artist.

13. SMOKING

- a. No smoking is permitted anywhere inside the building. Constitution Hall must investigate all reports or suspicions of smoke in any location of the premises, including dressing rooms.
- b. No open flames of any kind are allowed at any time anywhere in the building, including candles.

14. TRASH REMOVAL

- a. All trash produced by an event must be removed by the responsible party. No materials or equipment may be left at the end of a load-out.
- b. All trash produced by caterers must be removed by the catering company. Constitution Hall and its cleaning staff are not responsible for this task.

15. CLEANING CREW

- a. DAR has basic contracted cleaning staff for the purposes of cleaning the premises only, and only during regular office hours. They are not responsible for trash generated by an event or by the event's catering or hospitality.
- b. Restrooms will be cleaned once, typically prior to the start of the license period. Cleaning staff is not available to refresh or restock restrooms on demand.
- c. The Overtime Cleaning Fee that appears on the contracted schedule of rates is a charge for cleaning staff to come in on off-hours **following** the event to clean the building before the next licensee occupies the building. This charge is not for cleaning staff to remain on-site throughout the event.
- d. If your event requires cleaning staff during the event, there would be an additional charge of \$300.00 for two people during the 3½ hour event window.
 - i. This request must be made by e-mail to the Constitution Hall Event Coordinator no less than seven days in advance. Staffing is subject to labor availability.

CONTACTS

REQUIRED VENDORS:

Concessions:

Best Vending	India Robinson	(301) 404-1793	indiar.bestvendingdc@gmail.com
--------------	----------------	----------------	--------------------------------

Event Staff:

(LICENCEES ARE REQUIRED TO HIRE ONE OF THE THREE APPROVED VENDORS FOR EVENT STAFF)

Falcon Event Staff	Regi Miner Sr.	(202) 251-8080	regiminer1@aol.com
	Regi Miner Jr.	(301) 346-3594	regiminer@gmail.com
American Nat'l Protective Service	Loralyn Mayo	(202) 297-3415	lmayo.anpsllc@gmail.com
CES Security, Inc.	Krissy Herbster	(443) 471-7000	events@cessecurity.com

Ushers and Ticket Takers:

Theater Services	Karin Long	(301) 602-6865	njkarinl@aol.com
------------------	------------	----------------	------------------

Ticketing Services:

Ticketmaster	Natasha Smith	(757) 518-5509	Natasha.Smith@ticketmaster.com
--------------	---------------	----------------	--------------------------------

Stagehands, Riggers and Seat Removal:

GLP, Inc.	Robert Halem	(301) 341-1092	bob@glpproductions.com
-----------	--------------	----------------	------------------------

RECOMMENDED VENDORS:

Audio:

Maryland Sound	Bob Goldstein	(410) 448-1400	rtg@msihc.com
MHA Audio	Mike Scarfe	(301) 733-9337	mike@mhaaudio.com
Event EQ	BJ Singh	(410) 242-5050	bjsingh@eventeq.com

Lighting:

GLP, Inc.	Robert Halem	(301) 341-1092	bob@glpproductions.com
Atmosphere Lighting		(301) 585-2100	dcinfo@4wall.com
Event EQ	BJ Singh	(410) 242-5050	bjsingh@eventeq.com

Video/Projection:

Quince Imaging	Kelly Williams	(703) 742-7520	kwilliams@quinceimaging.com
----------------	----------------	----------------	-----------------------------

Platforming:

Jericho Stage	Roger Vill	(410) 477-1991 x201	jerichostageinc@gmail.com
---------------	------------	---------------------	---------------------------

Box Office Staffing:

Brave Soul Tix	Monte Wolfe	(202) 744-8823	bravesoultix@gmail.com
----------------	-------------	----------------	------------------------

Piano Tuning:

Katrina Sapp** <i>designated Piano Technician</i>		(703) 347-4430	sapptuning@gmail.com
Jerry Brubaker		(301) 336-6727	

Catering:

Taste	Alexis Jenkins	(443) 292-4064	info@humdingerenterprise.com
-------	----------------	----------------	------------------------------

Event Décor:

Hargrove	Ron Bracco	(301) 306-9000	events@hargroveinc.com
Legacy Scenic	Chris Gagen	(703) 961-8866	cgagen@legacysp.com

Furniture Rentals:

EventsBum	Pat Barnes	(240) 988-3915	pat@eventsbum.com
-----------	------------	----------------	-------------------

Theatrical Draperies:

Drapes and Drops	Leonard Weiss	(703) 823-4434	rentaldrapes@aol.com
------------------	---------------	----------------	----------------------

Valet Services:

Atlantic Services Group		(202) 466-5050	
-------------------------	--	----------------	--

Street Parking Meters:

DC DOT		(202) 442-4670	http://tops.ddot.dc.gov
--------	--	----------------	---